

Gold Certified Vindicator System Integrator

- Optimized and tested for hot desert conditions to 65°C (149°F) ambient and 70°C (158°F) operational temperatures
- Specialized heat-sinking internal architecture dissipates thermal energy away from camera body
- Reflective sunhood prevents glare in bright sun conditions
- Weather-sealed housing is dust-tight and sandstorm-ready
- 1/3" LXR CCD for excellent IR sensitivity, low smear, low streak and excellent anti-blooming characteristics
- MFP technology uses dual window (IR-Cut and IR-Pass) mechanical filter for optimised 24/7 performance
- Exceptional daytime color reproduction
- Outstanding night-time performance under infrared
- Photocell-controlled day-night switching
- 12 VDC / 24 VAC operation with VRB power protection
- Cast & extruded aluminum
- Easy access to lens compartment for adjustments
- IP66 and NEMA 4 compliant

Product Description

The EX27D-MX4 is specifically designed for day/night surveillance in hot, dusty desert conditions. An optimized heat-sinking design protects the EX27D-MX4 from internal overheating caused by solar heat gain. The EX27D-MX4 delivers reliable performance in 65°C (149°F) ambient environments and 70°C (158°F) operational temperature.

The EX27D-MX4 Desert camera incorporates MFP (Mechanical Filter with Photocell) technology. Using dual-window mechanical filter technology, the EX27D-MX4 delivers accurate color during the day and outstanding infrared sensitivity at night.

The EX27D-MX4 uses Extreme's proprietary LXR CCD technology for outstanding spectral response in both visible and near infrared regions. The high-resolution LXR sensor has low-smear, low-streak and excellent anti-blooming characteristics.

Using minimal mechanical moving parts, the EX27D-MX4 is weather sealed and tested to perform in hot desert conditions. Combined with Extreme's infrared illuminators, the EX27D-MX4 is ideal for day and night surveillance in desert and tropical environments.

Applications

- Extreme desert environments
- Tropical locations

Product Image

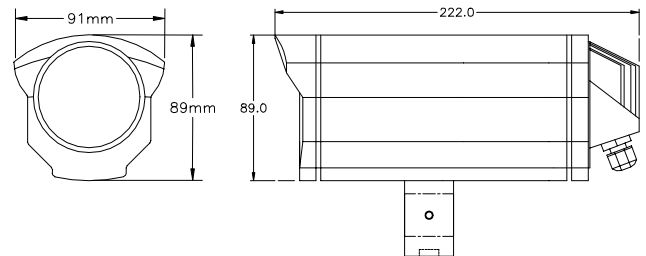

Conventional dual mode color / IR camera:
Video taken without MFP technology suffers from IR bleed and poor quality color.



MFP Technology: The same scene shows excellent color performance under Extreme's mechanical filter technology.

Specifications

(Other Special Order Models available on request)

CCD Camera	MX4 with MFP Technology
Image Sensor	1/3" LXR Interline CCD with enhanced IR sensitivity
Filter	Dual-window mechanical type, IR Pass / IR Cut
Day-Night Switching	Photocell-controlled, automatic
Effective Pixels	NTSC: 768 (H) x 494 (V) PAL: 752 (H) x 582 (V)
Resolution	550 TVL color / 570 TVL monochrome
Varifocal Lens Options	Varifocal 10-40mm IR corrected lens
Fixed Lens Options	3.6mm / 6.0mm
Signal Processing	Digital Signal Processing (DSP)
Output Signal	1V P-P composite video, 75 Ohms
Daytime Sensitivity	0.02 Lux with F1.4 lens
Night-Time Sensitivity	0 Lux with infrared (B/W)
Electronics Iris	1/60 ~ 1/100,000 (NTSC) 1/50 ~ 1/100,000 (PAL)
S/N Ratio	Greater than 48dB (AGC off)
Gamma	0.45
AGC	On
BLC	On / Off selectable
Voltage	12 to 24 AC/DC
Power Draw	4.5 W max
Construction	Robust aluminum casting / extrusion
Weight	3.1 lbs 1.4 kg
Finish	White powder-coated finish
Environmental	IP66, NEMA 4 compliant
Operational Temperature	-50°C to 70°C -58°F to +158°F
Mount	Double U-Mount Supplied with 1/4"-20
Sunhood	Included

Compatible Illuminators

Extreme CCTV infrared illuminators are tested for performance in extreme weather conditions.

The combination of the EX27D-MX4 camera and Extreme infrared is an ideal package for 24/7 surveillance in desert and tropical environments. MFP technology ensures no focus shift or IR bleed.

UF500
US Patent
#6158879



UFLED
Typical 10
year LED life



SuperLED
Rated "Excellent"
in US Army report



Part Numbers

EX27D-MX4.V140	Desert camera, MX400 with MFP Technology and varifocal 10-40 mm IR-corrected lens
EX27D-MX404	Desert camera, MX400 with MFP Technology and 3.6 mm fixed lens
EX27D-MX406	Desert camera, MX400 with MFP Technology and 6.0 mm fixed lens

Optional Accessories

EXPS.001	Power Supply Unit
EXMB.015	Pole Mount Adapter (use w/ EXMB.020)
EXMB.017	Wall Mount Adapter (use w/ EXMB.020)
EXMB.020	Versatile L-Bracket
EXMB.023	Wall Bracket

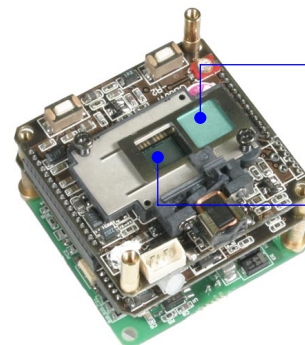

Day: IR-cut filter delivers accurate color by filtering IR light

Night: IR-pass filter, photocell-controlled, allows optimal performance in dark

Patent Pending. Specifications are subject to change without notice
 © Extreme CCTV Inc 2007. Extreme CCTV International Inc is a subsidiary of Extreme CCTV Inc

EX27D-MX4_TS_070101

Dealer / Distributor



Corporate Headquarters
Extreme CCTV Inc
 TF: 1 888 409 2288
 T: +1 604 420 7711
 F: +1 604 420 3300
 E: Sales@ExtremeCCTV.com
 www.ExtremeCCTV.com



European Operations
Derwent Systems Ltd
 A Division of Extreme CCTV (UK) Ltd
 T: +44 (0) 1670 730 187
 T: +44 (0) 1670 730 188
 F: +44 (0) 1670 730 188
 E: SalesUK@DerwentCCTV.com
 www.DerwentCCTV.com